

# 22.5 mm IEC Pushbuttons. Reliable. Modular. Global.

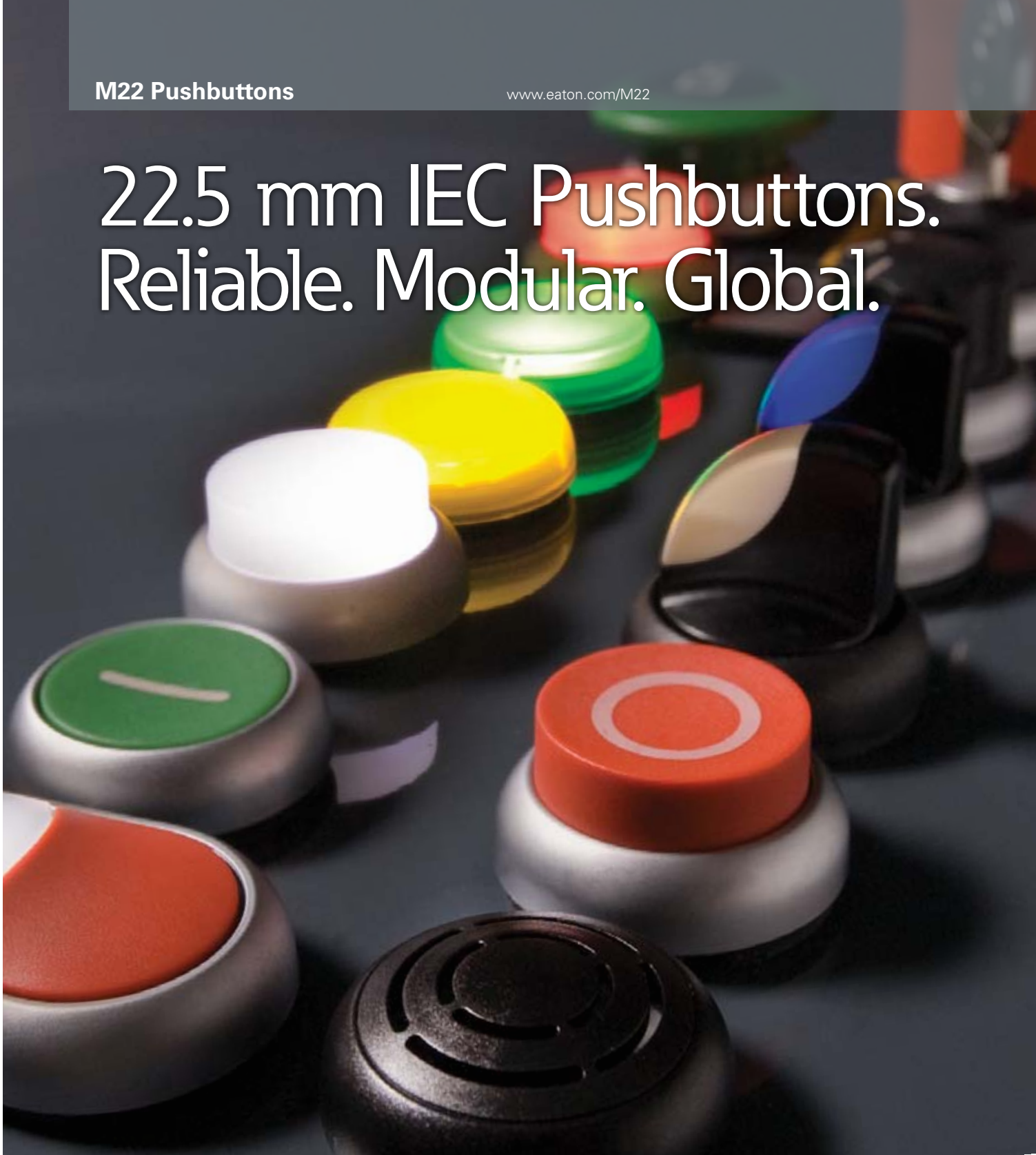

*Powering Business Worldwide*

# Designed for practical application

**The ergonomic design of the M22 product line** lends itself to practical application, regardless of whether it is installed in operator panels or in a control cabinet. The operators are actually shaped to fit the curve of the fingertip and indicator lights have specially designed lenses that achieve the highest illumination efficiency.

**When safety is a high priority**, clear color signals can make a difference, saving lengthy explanations and increasing machine safety. Internationally recognized colors represent specific commands and meanings—all of which are options for M22 operators. The illuminated pushbuttons and indicating lights show color in darkness or when there is interference from other light sources to provide safe, reliable, ultra-bright lighting no matter the environment or application.

**The LEDs used in the M22 line are vibration proof**—there are no wires that burn out or that are loosened by vibration—and can function continuously for 100,000 hours (equal to 11.5 years of illumination!). And the LEDs don't suddenly fail; the intensity of the light emitted fades, giving you the time to replace and keep control of your machine.

**Providing a high level of modularity**, the M22 features technology that allows for field conversion of pushbuttons and selector switches from maintained to momentary status or vice versa. With either a simple lever or coding adapter, you can change the status of your device—giving you more flexibility in the field and less inventory costs at the warehouse. Visit [www.eaton.com/M22](http://www.eaton.com/M22) for easy-to-follow video tutorials on this innovative feature.



The M22 line has a variety of emergency stop operators, even illuminated styles.

# Introducing M22

With a combination of advanced design and enhanced functionality, the M22 line of 22.5 mm IEC pushbuttons is perfect for a wide variety of global machine control applications. The product line includes pushbuttons, selector switches, pilot lights, mushroom operators and emergency-stop operators, as well more application-specific devices such as palm switches, four-way buttons, buzzers and communicating devices.

The M22 is ideal for OEMs, end-users and system integrators who value front panel aesthetics, maximum flexibility, and high quality construction. The M22 reflects Eaton's commitment to providing products that deliver increased reliability, functionality and time savings, while raising the industry standard in quality and versatility.

Through continuing investments, Eaton's electrical business has grown into a world-class provider of control and protection products. Meeting your specific needs means offering a complete line of motor protection, control and logic devices—all the latest in technology.

From contactors, starters and drives to pushbuttons, relays and programmable controllers, you'll have the edge when it comes to machine control solutions. Trust Eaton to deliver the products and solutions that will make your process more efficient and effective.





**Versatility made easy.** M22 devices provide the ultimate versatility in the area of device, legend plate and enclosure marking. All indicator lights, pushbuttons, legend plates and enclosures can be inscribed with any text or symbol via laser etching. Laser etching provides unmatched clarity and durability for standard or customized application requirements.

In addition, the M22 line provides efficient machine communications and reduces signal paths and wiring costs by using the cost-effective Actuator-Sensor Interface (ASi) network. The contact blocks provide the input signals and the LED

elements provide the output signals. Only one snap-on ASi terminal adapter is necessary—the adapter is an individual slave on the ASi string with its own address (1–62). Just two optional modules can make all M22 devices ASi capable.

Designed for global applications, the M22 family meets IEC/EN 60947, UL, CSA standards, as well as certifications for shipping and marine requirements. This line also meets SEMI S2/S8 standards required for semiconductor applications.

**More ways to keep you safe and your machines running.** Visible even in darkened rooms, the M22 illuminated

emergency stop operator helps ensure you are always safe and eliminates the need for separate indicating lights. And critical warnings can now be backed up by an audible alarm signal from the M22 buzzer, emitting a continuous and penetrating sound that warns of potentially dangerous situations.

The M22 line includes special operators and accessories to maintain safety and efficiency. Mushroom head pushbuttons with larger operating surfaces have a shape that is easily identifiable and distinguishable from other pushbuttons. Even more, these buttons are easy to

engage even when wearing protective gloves. Also included in the M22 family are key operated selector switches that ensure certain functions can only be carried out by authorized personnel.

For unfavorable environmental conditions, operators can be protected by diaphragms and plastic covers, ensuring adequate protection from the elements. Most M22 devices are protected to IP67 and IP69K standards, allowing for use in harsh environments and providing ease of cleaning—even with high-pressure and steam cleaners, an important benefit in applications where utmost cleanliness is vital.



A variety of operator types makes the M22 line flexible for your specific application needs.



Slide the small lever to change a pushbutton operator from momentary to maintained status.



3-Operator Control Station.

# M22 Product Overview

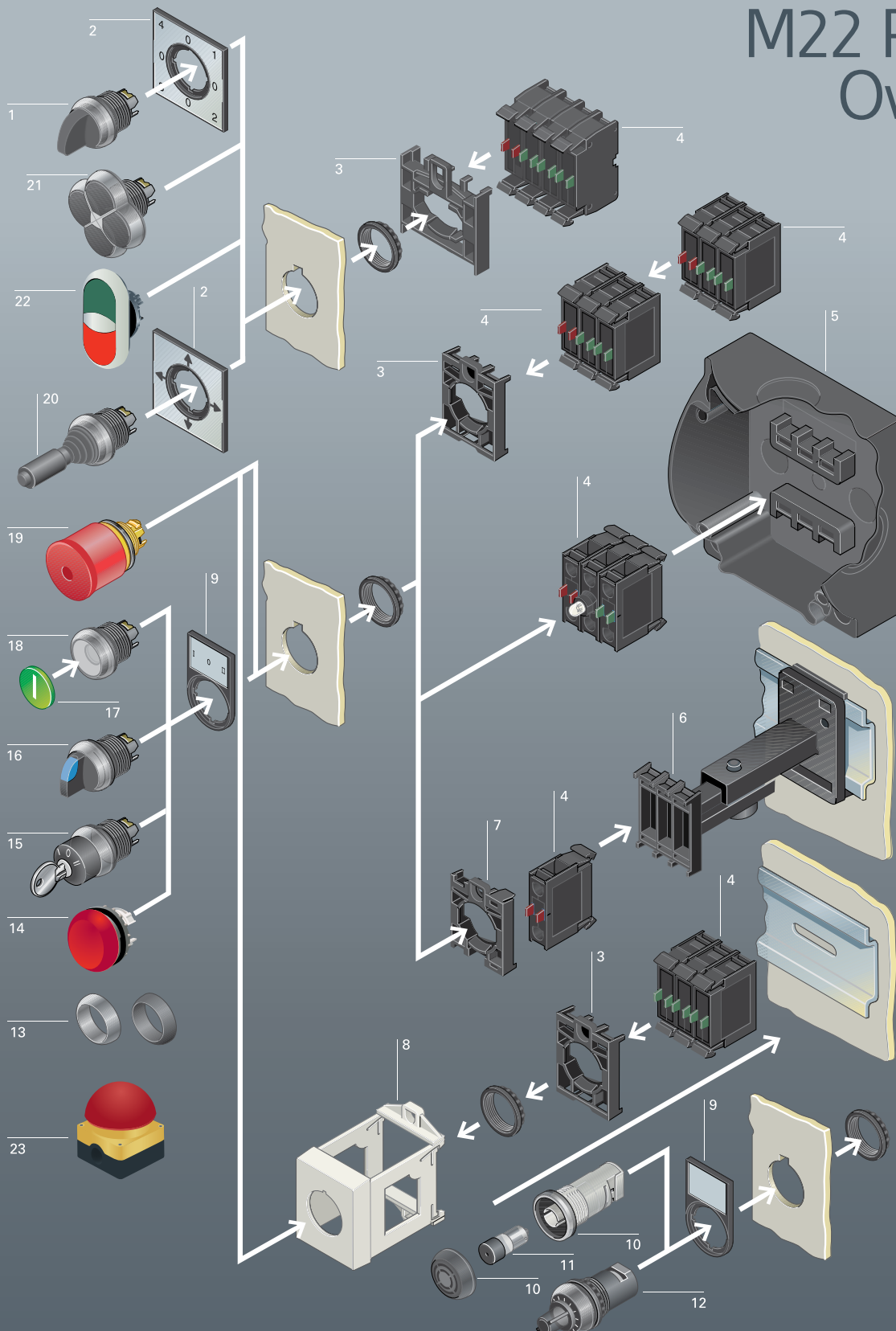

## Global 22.5 mm IEC Pushbuttons

- |   |                              |   |                             |
|---|------------------------------|---|-----------------------------|
| 1. Four-position selector switch                      | 6. Telescopic clip           | 13. Bezel, available in silver or black | 19. Emergency-stop operator |
| 2. Legend plate for four-way selector switch/joystick | 7. Centering adapter         | 14. Indicating light                    | 20. Joystick                |
| 3. Mounting adapter                                   | 8. DIN-rail mounting adapter | 15. Key operated selector switch        | 21. Four-way pushbutton     |
| 4. Contact block                                      | 9. Legend plate              | 16. Selector switch                     | 22. Double-pushbutton       |
| 5. Enclosure  | 10. Acoustic indicator       | 17. Button plate/button lens            | 23. Palm switch             |
|   | 11. Buzzer                   | 18. Buttonless operator                 |                             |
|   | 12. Potentiometer            |   |                             |

Eaton's Electrical Sector is a global leader in power distribution, power quality, control and automation, and monitoring products. When combined with Eaton's full-scale engineering services, these products provide customer-driven PowerChain Management® solutions to serve the power system needs of the data center, industrial, institutional, public sector, utility, commercial, residential, IT, mission critical, alternative energy and OEM markets worldwide.

PowerChain Management solutions help enterprises achieve sustainable and competitive advantages through proactive management of the power system as a strategic, integrated asset throughout its life cycle, resulting in enhanced safety, greater reliability and energy efficiency. For more information, visit [www.eaton.com/electrical](http://www.eaton.com/electrical).

**Eaton Corporation**  
Electrical Sector  
1111 Superior Ave.  
Cleveland, OH 44114  
United States  
877-ETN-CARE (877-386-2273)  
[Eaton.com](http://Eaton.com)

© 2010 Eaton Corporation  
All Rights Reserved  
Printed in USA  
Publication No. BR04716001E  
April 2010



*Powering Business Worldwide*



**PowerChain  
Management®**

PowerChain Management is a registered trademark of Eaton Corporation.

All other trademarks are property of their respective owners.